



T'Owd Man's

Mutterings

Issue 129

August 2014

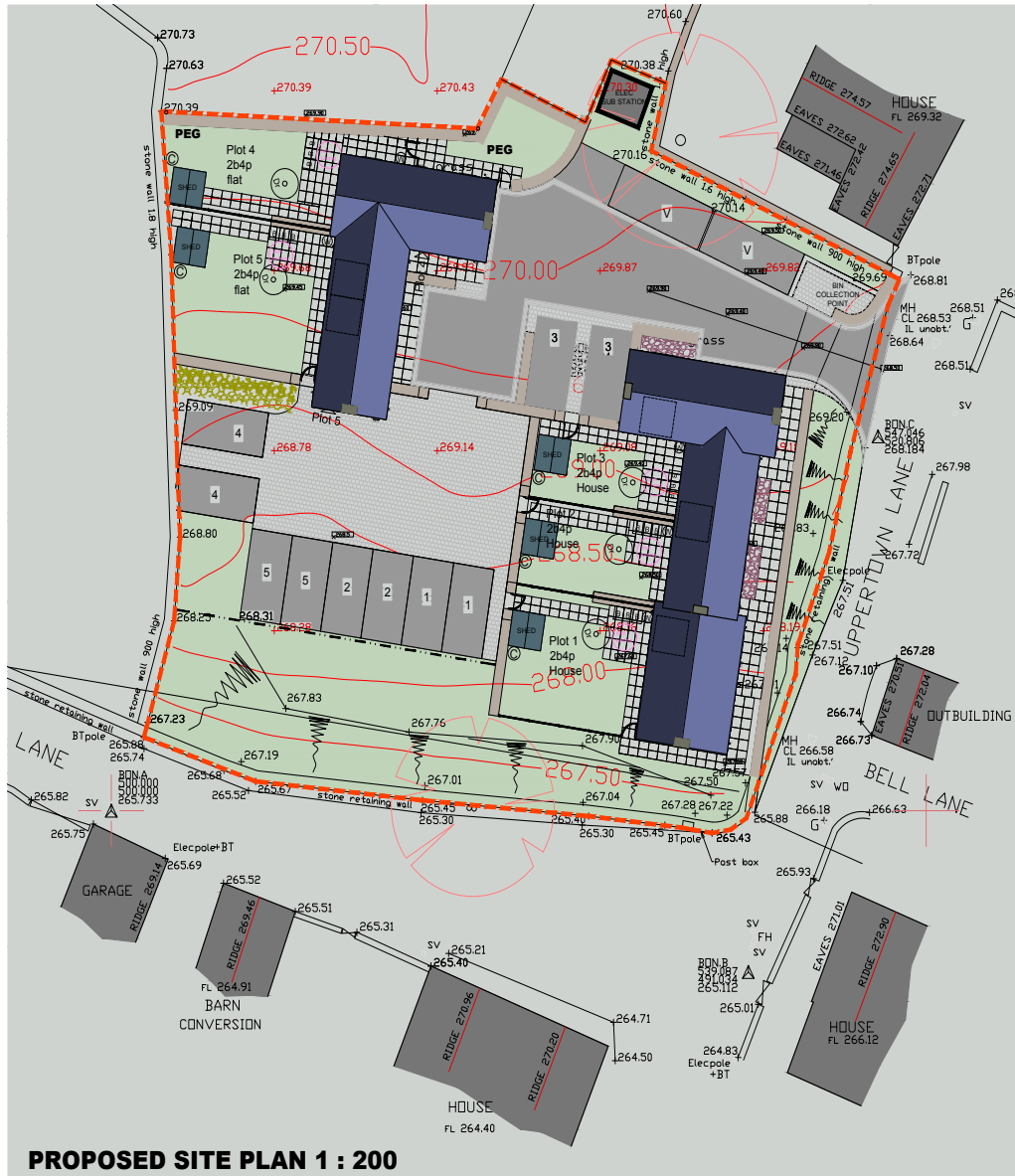

Plans for the affordable houses in Uppertown. See letters and Parish Council report for more details



In folklore T'Owd Man is a spirit that inhabits mines and caves. T'Owd Man of Bonsall is a carved figure of a miner that was taken to Wirksworth when St James church was being refurbished in the 1860s. It was said that strange noises coming from the old Ball Eye mine at the end of Church St. were of T'Owd Man muttering.

CHURCH NEWS



Hot air balloon over Masson Hill on midsummer evening

Catholic Church Services

Our Lady and St. Teresa of Lisieux

Gorse Bank, Wirksworth
Mass Sundays 9am, Holy Days 7pm
Contact Fr. Joseph Keogh
(01773 743336)

Our Lady and St. Joseph Church

Bank Rd, Matlock

Mass times Saturdays 6pm, Sundays 8.30am & 10.30am, Holy Days 9.30am & 7pm, Daily Mass Mondays and Fridays 7pm. Tuesdays – Thursdays 9.30am.
Sacrament of Reconciliation – Fridays 6.30–7pm, Saturdays 10.30–11am,
Adoration Thursdays and Fridays 7 am–11pm
Contact Fr. Bernard Needham (582804)

There is a fortnightly newsletter listing ongoing events. On Sundays breakfast is available in the church hall after the 8.30 Mass and tea/coffee and biscuits after the 10.30 Mass. All are welcome.

CHURCH DIARY

August

St James

- 3 9.30 am Morning Worship
- 10 9.30 am Eucharist
- 17 11.00 am Morning Worship
- 24 8.30 am Eucharist
- 31 9.30 am Sanctuary

Village Life Church

Summer Holiday Tots and Holiday Kids will be on:

Thursday 28 August

Thursday 4 September

From 10:00am to 12noon. (£1 entry per child)

Wesleyan Reform Church

Thanks very much to all who supported our Summer Lunch which raised £250 for the Flower Festival.

We also appreciate all the help and support given to produce the Well Dressing and the Flower Festival as we contribute to the village celebrations.

Sunday Services continue to be held at 6.15 pm

Friday 15 August, 2.00 - 4.00 pm

Cuppa & Cake afternoon

All are welcome to join with us.

Church Lighting

Carnival time sees the lighting again, in celebration of the lives of the Johnson and Kazebiatowski families.

John Sewry

Wirksworth Team Ministry

Serving All Saints' Alderwasley, St James' Bonsall, All Saints' Bradbourne, All Saints' Elton, St James' Brassington, St Margaret's Carsington, Holy Trinity Kirk Ireton, St James' Idridgehay, Holy Trinity Middleton and St Mary's Wirksworth.

Contact: The Team Office, Parish Rooms, St. Mary's Gate, Wirksworth, DE4 4DQ, Tel/Fax 01629 824707,
email:teamoffice@wirksworthteamministry.co.uk. www.wirksworthteamministry.co.uk

LETTERS

Dear Editors,

I attended the Parish Council meeting on 15 August along with 35 or so other parishioners (where are you all when the elections for the Parish Council come round? We are entitled to eight councillors). The meeting was almost entirely dedicated to the proposed development in Uppertown of five affordable units of accommodation. The Chairman flexibly allowed public contributions beyond the time allocated in the agenda. I was impressed with the way in which the objectors put forward their reasons for objecting to the proposal. One person spoke in favour of the proposal.

District Councillor Purdy, as befits an ex-Police Inspector, listened to the evidence and explained the planning process and dealt with some of the issues raised. The applicants explained how they had assessed the housing need in Bonsall and their efforts to find sites in Bonsall and adjoining villages. The architect dealt with some of the queries on the plans. Inevitably a dialogue was not possible as answers gave rise to further questions which the Parish Council undertook to collect and obtain answers to. The Councillors debated the issue and supported, with conditions, the proposal by 3 votes to 2. This reflected the reality that, whilst this is not the ideal site, it is the only one available. Compromises have to be made, the impact of which will bear most heavily on a few residents, to ensure the vitality and diversity that the village needs to thrive. As an ex-parish Councillor (1979-2002) I offered my congratulations to the Council members for the way they had handled a very emotive topic. **Peter Greaves**

Dear Editors,

Whilst I applaud Thomas Harris's efforts to promote environmental awareness and understanding of planning implications among young people, I do think he has to widen his own understanding of the issues if his generation is to be any more successful in defending the planet than my generation has been. He is right to be concerned about the additional wind turbines planned for the landscape on the other side of the Via Gellia from Bonsall. The District Council opposed the existing wind turbines but have not been supported by the Government Planning Inspectors. So while I share his concerns about more turbines interrupting the views from Bonsall, Slaley and Ible, I don't think

we will get much support from Central Government. I should also say that I think there is a strong ecological case for wind turbines as a way of meeting our growing energy needs. Certainly they have less damaging ecological implications than the use of fuels from coal, fracking, shale and nuclear means. To my mind the real issue is not to throw out all applications for wind turbines but to prevent their wholesale proliferation on small areas of the landscape like the moors below Bonsall, a view I have already made to the Southern Area Planning Committee which will determine the application. Ultimately, the need for new sources of energy will not diminish while there is an expansion of new households and an increasing use of appliances within all households. Sadly green efforts to ensure that more homes are energy efficient and that we are less dependent on household appliances have fallen largely on deaf ears, including those of the young who probably make even greater use of those appliances than I did when I was their age.

I should imagine that many in his generation thirty years ago might also have raised his other concern about the way new housing has cut into the open landscape. Over that timescale sensible planning policies have meant new housing development in Bonsall has been restricted but it did not prevent the development of the house Thomas now lives in and others in Uppertown which were also built on what was then open landscape. So it is somewhat unfair for him to live in a nice new house in the village whilst denying that right to other young people, and is also a very selective acceptance of the need to defend the environment. Once again this issue is much larger than Thomas suggests. Over the last five years, certainly, house values have increased while earnings have stagnated and even fallen in the Derbyshire Dales. This means that young people are increasingly unable to afford houses in places like Bonsall unless they can depend on significant help from parents. While that is the case, villages like Bonsall which previously supported a mixed population with widely differing incomes are now becoming enclaves of the better off. So Thomas, I think the Parish and District Council are justified in seeking to increase the numbers of social housing in Bonsall and the

Derbyshire Dales. That said, it does not mean that I will ignore all the other appropriate issues before I decide on the Chestnut Farm application. Fortunately Thomas, District Councillors can't make planning decisions on the basis of those we are happy with and disregard all the others. If young people in the village do want to get a better understanding of the intricacies of planning process I really do suggest they attend a few of the District Council Planning Committee meetings. I shall be happy to provide the dates of the meetings. Perhaps, I should warn you a lot of the business will bore you rigid, but the other elements may give you a better idea of the increasingly difficult decisions that councillors have to make, especially those that have serious ecological implications.

Bob Cartwright

Mick Moor Installations

*Sycamore Cottage
Puddle Hill, Bonsall,
Tel: 01629 824376*

Mobile: 0797 4720991

See the vast range
of services offered by
a small, private, local
company:

www.mickmoor.co.uk

Now updated with pages
and pages of things
for sale!



01629 825832

Opening Times:
Monday - Friday 7am - 5:30pm
Saturday 7am - 12:00

**Unit 1, Via Gellia Mills,
Bonsall, Matlock, DE4 2AJ**



The Play Mill

Via Gellia Mills, Bonsall DE4 2AJ
Telephone: 01629 824777
www.playmill.co.uk



- Climbing Frame
- Sandpit
- Sit and Ride Toys
- Hot and Cold Food



- Yoga Bugs, Mondays at 11am
- Singing. 1st Wednesday in the month 1pm
- Craft. Thursdays at 11am
- Dinky Dancers Fridays at 11am



Indoor play for 1 - 8's (or less than 4ft 8")

Birthday Parties from £7.95 per child
Under 1yr 50p . 1-8yrs £4 for 2 hours
Open 10am - 6pm, 6 days a week
Fridays 10am-4pm

Local milk from local farms

Early Morning Deliveries from

David Allsop's Milk

Round

Fresh Milk
Organic Milk
Soya Milk
UHT Milk
Cream
Eggs



Fruit Juices

Milk and Eggs now also
available 24/7 from the
vending machine at Via
Gellia Mill
To order call 01629 824795

Auto Engineering

18 Yeoman Street



Service and MOT
preparation
All makes of vehicle

Tel: 824537/822708

Fax: 01629 822708

LETTER/VILLAGE NOTICEBOARD

Dear Editors

After many months of would'a, should'a, could'a I decided to take the plunge and start training to become a Life Coach, I will be qualified by the end of the year. 'Whats a Life Coach?' I hear you say, well it's a transformation process from where you are now and bridging the gap to where you want to be. Coaching is a process that transforms wishes, dreams and good intentions into reality.

'Coaching is the art of facilitating the development, learning and enhanced performance of another' – Peter Hill, in Concepts of Coaching

So that's what coaching is! What I need is 3 volunteers to be coached. I need to practice what I have learned so far. It would mean you giving up around 4 hours of your time, spread over 4 separate sessions. The first session would be a 'chit chat' to discuss varying stuff and seeing if we can uncover a goal that you would like to reach. Then 3 separate coaching sessions, this could be in the comfort of your home, my home or I am happy to hire a private room, where-ever you feel comfortable (apart from beach locations unless you are paying!). It will be on first come first served basis as I am limited to 3 places.

This is a fully accredited Level 5 Management Diploma. So I am professionally (and morally) bound to confidentiality. The Diploma in Performance Coaching is accredited by EDI (Education Development International) – a UK based qualification, NCP (National Council

for Psychotherapists) – a UK based professional psychotherapeutic regulatory body. And I am training with Simply Changing (please go onto the website and look at the amazing work they do) who will contact you to ensure that you have given your permission to work with me. If you are genuinely interested please contact me via email beckyleash220@yahoo.co.uk. I look forward to working with you and many thanks.

Becky Colburn

WHAT'S ON

August

Kings Head

9 Mandy & Dave's karaoke

30 Tony's karaoke

Sundays - Quiz Night

Barley Mow

2 World Championship Hen

Races

7 Film Night

Friday Nights - Music Club -
Open Acoustic Session

New Village Shop

Thanks to the support of our loyal customers over the past two years, we are proud to announce that we will soon be opening your local village shop and delicatessen. Our range will include convenience provisions such as fresh bread, milk and vegetables, often forgotten items such as tins of beans, shampoo etc and more specialist meats, cheeses, chutneys, including local produce wherever possible. Another idea is homemade takeaway meals suitable for busy households and we would like to reintroduce home deliveries, maybe every Friday, as Peter Wells used to do back in the day! We are also looking into a licence to sell a selection of wines and locally brewed beers etc. Welcome packs for visitors to village holiday homes will be available as well as seasonal hampers for Easter and Christmas. This could also extend to the supply of picnic hampers for visitors. We will also extend our focus to include outside and event catering. Other ideas and suggestions will be more than welcome and thoroughly appreciated.

Ade, Anne, Jake and Alix.

Bake Love

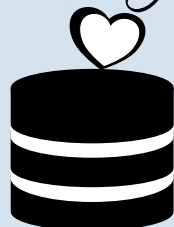

Bespoke Cakes

Rising to the occasion

- ♥ You Choose the flavour
- ♥ You Choose the style
- ♥ You Choose the theme
- ♥ You Choose the date

For further information please contact Doro Maginnis
Telephone: 01629 820132
Address: 1 Church Street, Bonsall, DE4 2AE
www.facebook.com/bakelovebespokecakes

VILLAGE NOTICEBOARD

Carnival Help

If you are enjoying this year's carnival, please have a think about how you might be able to help make next year's just as successful. There are currently eight members of the Carnival Committee (plus many more people who help out during Carnival Week) and there are a lot of jobs that need doing - often just small things but it is important that someone does them (see some examples in the extract below from the minutes of the last meeting). We are also looking for more people to be stewards at the fireworks events in Matlock Bath on September 27, October 4, 11, 18 and 25. If you would like to help out in any way that suits your time and availability, please get in touch with **Hazel** on 824724.

Meeting of the Carnival Committee, 1 July 2014 at the Kings Head

Run-up to Carnival Week

- ☐ Mark will erect the gazebo on Friday night.
- ☐ Parking on Black Tor Road is sorted.
- ☐ Mark reported that the carnival opener's script is done.
- ☐ Leigh will remind the skip supplier
- ☐ Hazel has organised the waste bins.
- ☐ Julie has organised the signs and publicity.
- ☐ Leigh reported that Krystina has organised teas in the Village Hall.
- ☐ Maintenance on the ducking stool is complete.
- ☐ Hazel will do a 5-minute interview with Radio Derby at 10.45 am on Saturday.
- ☐ Hazel reported that a first-aider will attend for the day.
- ☐ Hazel has bought sweets for the fancy dress and sports.
- ☐ Mark will organise the stage music equipment.
- ☐ Hazel will help Julie with children's sports.
- ☐ Money from programme sales was received from Mark and Wendy.
- ☐ Keith will supply cash floats for the carnival stall, ducking stool, treasure hunt and Village Hall.
- ☐ Keith will organise prize money for floats, the three fancy dress age groups and the best dressed house.
- ☐ Julie and Keith will collect money on Carnival Day.
- ☐ Wendy has organised lantern making at the school and has a design for the fire picture.
- ☐ Mark will put cones out on Friday night and also on the following Friday for the fireworks.

Action by:

Mark

Leigh

Hazel

Mark
Hazel/
Julie

Keith

Keith
Julie/
Keith

Mark



1940s Lunch

Some members dressed up in 1940s costumes when they enjoyed a lunch at the Wesleyan Reform Chapel. 36 people attended and donations, which amounted to £250, were made for flowers for the Flower Festival that takes place during Carnival week. **Norma Marshall**



Cromford Garage

MOT, Service and Repairs
to all makes of vehicles

Now selling & repairing
tyres

Book in on **01629 823043**
or **07885 879652**

Hollies Farm Plant Centre

Uppertown, Bonsall, DE4 2AW
01629 822734

Unusual Perennials, Bedding and
Basket Plants, Hanging Baskets,
Compost. Free Range Eggs.

Display Garden Open March -
October, 9am - 5.30pm every day
except Wednesdays.
www.holliesfarmplantcentre.co.uk
Find us on Facebook

Brew Bikes

Cycle Maintenance in the
Peak District

For all your cycle servicing,
maintenance and repairs

Call Brew on 07870 496737

Collection and delivery service
Competitive rates

Brew@peakcyclemaintenance.co.uk
www.peakcyclemaintenance.co.uk

City & Guild qualified and fully
insured

VILLAGE NOTICE BOARD

Grandad remembering the good old days...

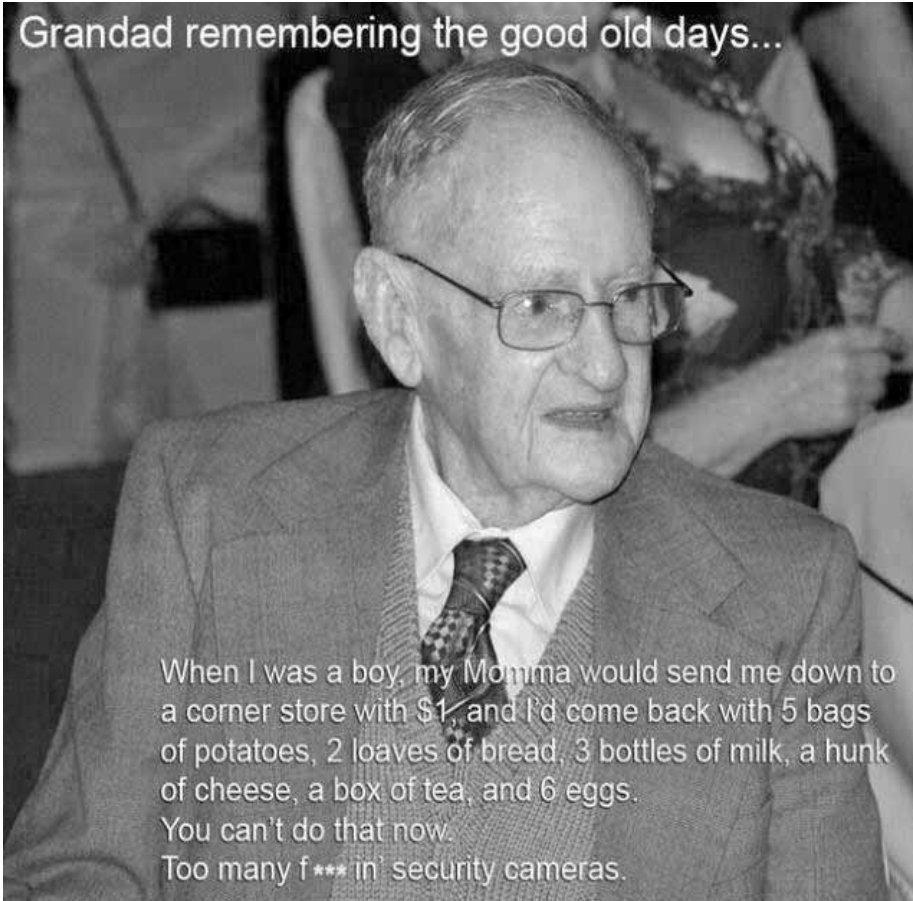

When I was a boy, my Momma would send me down to a corner store with \$1, and I'd come back with 5 bags of potatoes, 2 loaves of bread, 3 bottles of milk, a hunk of cheese, a box of tea, and 6 eggs.
You can't do that now.
Too many f*** in' security cameras.

kf

accounting services

SERVING BONSALL
AND DISTRICT

FREE INITIAL CONSULTATION

01629 55255

81 DALE ROAD
MATLOCK
DE4 3LU

CHARTERED MANAGEMENT
ACCOUNTANT

With thanks to **Dave Headon**

Open Gardens Weekend

A big thank you to everyone who took part and helped to make the weekend a huge success. We not only had the garden owners but a team of volunteers who sold tickets at the Fountain so thank you to Jane and Alan David, Claire Taylor and Anne Hambly for giving their time. We had several new gardens which really raised the level of enjoyment for the visitors who

came from far and wide. There were so many positive comments from them. Some had been coming to Bonsall for years and others new to the Bonsall experience said that they look forward to coming back again next year. The weather was not great at times but it did not deter keen garden inspectors from arriving at 10 am in weatherproof clothing! All this is really positive for the future of Open Gardens and each year

we are getting a little better organised! The total raised was £1600 and, after costs for two new banners and printing tickets, the net total was £1446.39. All the money goes to village causes which include the Church, the School and the Bonsall Pensioners. We will post a list in due course of the amounts given.

Olivia Gerrish and Liz Stoppard

CARL TAYLOR

LOCAL BUILDER AND
ROOFER

ROOF REPAIRS TO FULL
ROOFS

EXTENSIONS TO NEW
BUILDS

CONSERVATORY BASES,
PATIOS, GARDEN WALLS
ETC.

FREE ESTIMATES

**NEW NUMBER
0779 1161919**

INSURANCE THAT'S ON YOUR DOORSTEP



Having a local office means we're accessible, whether you need to make changes to your policy, make a claim or need financial advice.

We can help you with:

- Home & Car Insurance
- Business & Commercial Vehicle Insurance
- Retirement Planning
- Protection

NFU Mutual Financial Advisers advise on NFU Mutual products and selected products from specialist providers. We'll explain the services we offer and our charges.

For a real conversation
about your needs call
01629 582025



It's about time®

Agent of The National Farmers Union Mutual Insurance Society Limited.

High quality local builders.

Architect approved.

Fully qualified.

30 years experience.

If it is a new build, extension,
restoration or repair .

Contact **RICHARD WEBSTER**

on 01629 824724

Mob 07812 348283



VILLAGE NOTICE BOARD

A Short History of Chestnut Farm

It is believed that the former name of the farmhouse was Bonsall Old Hall and it may have been a small manor house that was owned by the Harding family for nearly 250 years from 1620 to 1864. The house, outbuildings and three fields amounting to eight acres and two perches were then bought by Miss Woodiwiss for £845 (£36,470 today) to rent out. The year of the sale ties in with the date of alterations to the house, possibly prompted by a substantial fire. The front elevations date from the 1860s with much older sections at the rear. The two sets of rear windows in ecclesiastical style may have been added from another building, possibly during the 1860s alterations to St James' Church. During the 1920s, the Assembly of God Church held their first services in a room at the farm and during the 1930s 'Jesus Saves and Satisfies' was written in large letters on the barn doors in the gable end. In 1946 John and Clara Marples bought the farm and it was around this time that a row of chestnut trees, which gave the farm its name, was felled and the inscription on the barn door painted over. Fred Marples, the son of John and Clara, continued to live and farm there until his death in 1997.

Liz Stoppard, writing in Issue 103 of Mutterings in 2012 recalled Fred as follows:

"I was sitting in old Freddie Marples' kitchen at Chestnut Farm. I always went to Fred's for a late afternoon cup of tea by the warm fire-lit old range.

It transported me back into a time more gentle than the present. The old grandfather clock chimed in the corner, a hen popped into the kitchen for fallen crumbs, cobwebs collected quietly in the corners of the kitchen for what must have been millennia. Yet here was perfect peace for me, with Fred, always with his Park Lane cigarette hanging from the corner of his mouth talking about farming or gossiping about other farmers he knew at Bakewell market. In his later years the whole household had moved into the kitchen including his bed. Must have been the warmest place. The rest of the farmhouse was an untouched memorial to his parents now long gone. It was if they had just left the room. A preserved Victorian parlour with its original wall paper, antique furniture and ornaments. Joe came in through the kitchen door with a bucket of coal for the fire. At 74, Joe was described by Fred as his 'farm boy'! Mind, I once saw him hop clean over a metre-high stone wall. Fred always wove a magic tale about so much of Bonsall. Always intriguing, full of fun with lots of characters in them, ranging from the old vicar in the 1950s, his headmaster, Miss Prince from the Study mansion and all sorts of local characters now long-gone. He was a book and his stories and his delivery of them while sitting in a threadbare old armchair by his kitchen fire were some of the most treasured moments I have ever had." After Fred's death the farm was inherited by a nephew from South Wingfield who began to convert the farmhouse and barns to eight holiday

properties, bringing to a close over 375 years of farming at Chestnut Farm. The alterations were completed by the present owner, who also sold the adjoining field and offered the smaller plot, adjacent to Uppertown Lane, to Nottingham Housing Association to build affordable housing. This proposal is currently under consideration by DDDC and is being contested by the Bonsall Rural Action Group.

Further details of Chestnut Farm are available in the second edition of 'Bonsall - a village and its history' available from 19 High St. or the History Group website at www.bonsallhistory.org.uk/Goods.html

Peter Fellows



Taylor's Fuels COAL

£11.50 per 50KG Bag*
(£230 per ton)

NEWBURN

**Long burning smokeless ovals,
ideal for glass-fronted room
heaters, multi-fuel stoves and
wood-burning stoves.**

£14.50 per 50KG Bag*
(£290 per ton)

Tel: 01773 741 212

**We guarantee the quality of all
the fuel we sell.**

Minimum Order Applies.

***fuel supplied is not pre-packed**

Townhead Farmhouse+ B&B

**Comfortable ensuite rooms,
wonderful breakfast from the
AGA & a log fire for those chilly
evenings.**

**Self catering also available.
Special offers available for
longer stays.**

Telephone: 01629 823762

townheadfarmhouse@btinternet.com
www.townheadfarmhouse.co.uk



WWW.BARLEYMOWBONSALL.CO.UK

THE TRUTH IS OUT THERE...
BUT THE BEER IS IN HERE!

- ★ 3 or More Real Local Ales served. ☒
- ★ Large Choice of Home Cooked delicious meals. ☒
- ★ Great Atmosphere. ☒
- ★ Large Car Park. ☒
- ★ Alien Visitors. ☒
- ★ Acoustic Jam Sessions Friday. ☒
- ★ Top class entertainment every Saturday night. ☒

Hope to See You All Soon . . .

01629 825685

PARISH COUNCIL

Report of the Parish Council meeting held on Tuesday 15 July.

27 members of the public attended the meeting where Councillors were due to vote if they held an objection to the planning application put forward for affordable homes at Chestnut Farm in Uppertown. This issue dominated the meeting and the following is an overview of the issues raised. Residents of Uppertown presented their cases based on:

- 1) The case for new dwellings in Bonsall not having been proven through the surveys.
- 2) The impact on the conservation area.
- 3) The dominance of the proposed buildings on the local skyline.
- 4) That a previous planning application for Chestnut Farm had been refused on the grounds that it was unnecessary development.
- 5) That the materials proposed are cheap and not in keeping with the dwellings in the area.
- 6) The proposals are not in line with the Village Design Statement.
- 7) The existing problems with traffic congestion and speed on Uppertown Lane will be made worse by the development.

Additional issues raised, relating partly to the development, were general speed of traffic in the village, the 30 mph speed limit does not apply to Uppertown and cutting back in vegetation in The Dale – Cllr. Purdy will raise these once again on behalf of Bonsall residents. One member of the public spoke in support of the development and noted that it did not contradict any current planning policy. Cllr. Purdy noted that if members of the public wish to make representations at the District Council meeting where the decision will be made by DDDC on whether planning permission should be given for the development, they should contact DDDC directly to register. This needs to be done by 12 noon on August 4. A site visit will take place on the same day and Cllr. Purdy will endeavour to let the Clerk know the time so that she can circulate it. Isabel Frenzel (DDDC), Rachel Hutton (Nottinghamshire Housing Association) and Barbara Stillman (Pelham Architects) then made a presentation to Councillors

to provide additional information about the planning application and the development generally. Isabel: DDDC have a statutory duty to look at housing need in villages and where a housing need is identified, to find ways to meet those needs. This work is not related to local plan requirements and is undertaken with each village using 'exception site policy' to provide affordable housing. Currently, the cheapest property to buy in Bonsall is a two-bedroomed house at £172k. This creates a real issue in keeping young families and older people in village. In 2007 a survey identified 16 households in need. From a walk around Bonsall with Parish Councillors and a Planning Officer to assess available and suggested sites identified Chestnut Farm. There are only ten affordable homes, two have been lost since 2007 through the right-to-buy scheme. There are no sites available in Matlock Bath and Cromford; there is one site in Winster but the landowner is not willing to sell. Perfect sites don't exist. Sites have to be submitted as part of planning application. Surveys have to be updated so that current information is used. Building standard is higher than available on the open market and the funding is grant funding to supplement the build costs. With regard to the housing being allocated to local people with a strong local connection, the 'exception site policy' allows a local letting scheme to be put in place, which means that to qualify for housing anyone must have a five-year local connection to Bonsall or an adjoining parish. Additionally a local letting scheme will also be put in place to discount applications from Matlock. The housing will never be subject to right-to-buy.

The Highways Dept. was consulted prior to the application and provided advice to move the access 20 metres from the junction and remove a section of dry-stone wall. The wall will be rebuilt by a dry-stone waller further into the site to improve visibility. Regarding parking and the number of spaces, any new-builds must have off-street parking. The well will be protected throughout the construction phase and it will stay in place. There will be three houses at the front and two flats at the back. Gardens will be maintained by the housing association. Regarding the height, a site section drawing with the planning application was taken from a topographical survey.

Materials are to be confirmed with the planner and will be required to be checked those throughout the building process. While the chimneys are non-functional the planners will confirm what the exterior material should be. They will not be plastic.

Questions included: How was the needs survey carried out?

Housing needs were measured via postcard and online surveys and meetings and interviews with respondents. Results were compared against the type and turnover of private rented housing in the village. Financial information was provided and the current housing situation assessed. Joining housing options puts you in Band D unless you state your case and provide evidence. This requires people to be actively involved to change bandings. A private renting survey showed £620 pcm for the single available property. 85% of villagers are owner-occupiers and 50% of those have paid off their mortgages. Only 15% of housing stock is available for private rental. Because of tenants' protection, houses can't be sold if used as affordable housing and private landlords are not able to build these developments - only housing associations can.

How affordable are rents?

An affordable rent is 80% of market value. For flats = £105 per week, houses £114 per week, which includes service charges. Market rent for a two-bed house is £138 and £550 per month for apartments. Houses are level-3 energy efficient and so cheap to run.

Have alternatives been considered?

New homes are part of a wider strategy. There is shortage of housing for smaller households. The Council is looking at homelessness prevention. There are big issues with debt in Derbyshire Dales and it is working with Age UK to help with home options and support discretionary housing benefit. Also looking at re-designating older people's houses for younger families as population needs shift.

What would be the Impact on local people of not developing the site?

People would have to move away or continue living with parents/other unsatisfactory arrangements.

What will be the impact on the local

PARISH COUNCIL (CONTINUED)

community?

Keeping a balance in the community. 84 school pupils, up from 32 and in danger of closing. A third of pupils were living in affordable housing so a positive impact on local services like schools.

Is it linked to travel to work? Moving housing to Matlock?

The aim of the project is to meeting housing needs of people in the village – that's where the strict criteria of local association comes in. People are working and living in different ways. Bonsall is only four miles from Matlock. There is no settlement boundary around Bonsall, so houses can be developed on the outskirts. Further development:— plans show no further development and the client has reserved no accesses – as far as Nottingham Housing are concerned that is as far as the development goes. Following a lengthy discussion, the Parish Council voted by a majority of 3:2 to state that while they had no objection to the development they had the following concerns about it:

1) The proposed height of the development. The plans indicate that the new development will be some 1.8 metres higher than surrounding skylines. This will be dominant in the skyline both to immediate neighbours and to the area. This should be minimised.

2) Traffic movements in the area need to be fully considered and the Parish Council would like reassurance that this will happen as there is a fear that traffic moving in and out of the development may create danger in an already congested, narrow road.

3) The materials used to build the development must blend effectively with the surrounding areas. Concerns were expressed that there was no clear detail on this on the plans and that it was possible for example to get the impression that the chimney pots would be made of plastic. The Parish Council have listened carefully to the concerns of those residents who are concerned the development would look out of place and would urge DDDC to ensure that the highest quality materials should be used which will blend into the surrounding area. The next meeting of the Parish Council will be on Tuesday 19 August at 7.30pm.

Catherine Rawas

Parish Councillors

If you have any concerns or requests of the Parish Council, they should ideally be raised in Public Participation section of the monthly meeting. If however there is an urgent matter, while individual councillors will try to assist, a direct response is better achieved by contacting the Clerk to the Parish Council directly:

Chair: Cllr Dorothy Lane,
55 High Street, T: 824941

Vice-Chair: Cllr Denise Pountain,
6 High Street, Bonsall, T: 822708

Councillors:

Cllr Terry Henderson, 17 High Street,
Bonsall, T: 825782

Cllr Veronica Addis, Dale House,
The Dale T: 826309

Cllr Colette Dewhurst, The Barley
Mow, The Dale, Bonsall. T 825685

Responsible Finance Officer

Tony Payne, 27 High Street.
T: 822311

Clerk:

Catherine Rawas, Brocliffe Cottage,
Uppertown, Bonsall DE4 2AW T:
820947. M: 07964 053129
e-mail: bonsallclerk@googlemail.com

The public toilets at the Fountain will be shut from around 6.30 pm until about 9am until further notice due to vandalism that took place last week. The toilet roll holders were removed from the walls in both the ladies and gents. They were bent out of shape and toilet paper was spread all over the stalls. It appeared that people had been smoking in there as well. The Parish Council now has full responsibility for the toilets and has to pay for the repair of any damage and extra cleaning needed. Please consider others when using the facilities. **Catherine Rawas**

THE KINGS HEAD

Your village pub

Offers you a warm welcome, with real ales & real food for real people. Traditional Bateman's ales with weekly guest ale. ****NEW POOL ROOM**** Home-cooked traditional food served Tues - Sat 6.00 - 8.30pm. Sat lunch 12 - 2pm; Sun lunch 12 - 2.30pm.

Lite lunch menu soon available

Pie Nite on Wednesdays

Steak Nite on Thursdays

Opening times:

Mon: from 7.30pm.

Tues-Fri: 5.30pm-12am.

Sat: 12-3pm and 5.30pm-12am.

Karaoke 2nd and last Saturdays.

Sun: 12-3pm and 7.30pm-12am.

Quiz night every Sunday.

Phone **Michael** on **822703**

District Councillors

Bob Cartwright, tel: 822702, bob.cartwright@derbyshiredales.gov.uk

Garry Purdy Tel: 823636, garry.purdy@derbyshiredales.gov.uk

County Councillor

Irene Ratcliffe, tel: 823023, irene.ratcliffe@derbyshire.gov.uk

Member of Parliament

Patrick McLoughlin, Derbys Dales constituency, tel: 020 7219 3511, House of Commons, London, SW1A 0AA, email: patrick.mcloughlin.mp@parliament.uk

MEPs

The 6 East Midlands MEPs can be contacted on 020 7219 3000 or at: House of Commons, London, SW1A 0AA

GARETH BLOOD

CHIMNEY RE-LINING

STOVES FITTED

01629 825533

YOUR FRIENDLY LOCAL
TEA ROOMS, OPEN DAILY
FOR BREAKFAST, LUNCH,
HOT AND COLD DRINKS,
CAKES ETC. MONTHLY
THEME NIGHTS

PLEASE ASK FOR DETAILS

Comfortable
B&B
accommodation
and holiday
apartment



1 Yeoman Street, Bonsall,
DE4 2AA Tel: 01629 824814
www.thefountainbonsall.co.uk
enquiries@thefountainbonsall.co.uk

The first correct crossword pulled out of the hat on August 10 will receive a copy of *T'Owd Man's Walk - in search of Lutudarum* by Alan Edwards. Please post or deliver your entries to 19 High St

Collective Nouns

What do you call a group of cuckoos?

**ROBIN MAYCOCK FAMILY
BUTCHERS & BAKERS
FREE HOME DELIVERIES
TO BONSALE EVERY FRIDAY
MORNING.**

Beef, Lamb, Pork, Free range Chicken.
10 varieties of sausage.

Meat pies, Ready Meals, Puddings,
Cheese, Eggs Fruit & Veg
& much much more.

**OUTSIDE CATERING OUR
SPECIALITY**

Call 01629 534333 for a brochure
& product list or view our website at
www.robinmaycockbutchers.co.uk
We also supply the Barley Mow Inn
with meat for their wonderful bar meal
menu.

PRIZE CROSSWORD No 53

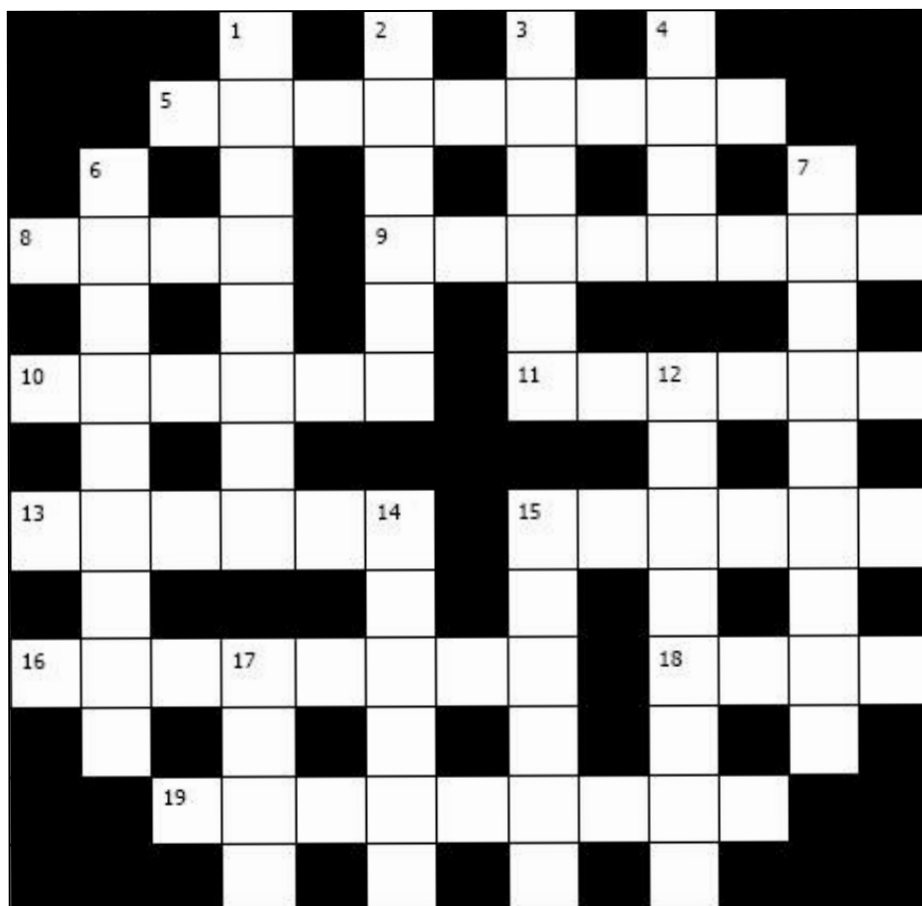

Across:

5. Bird that's upset eating rotten cone. (9)
8. Unruly prom frolic. (4)
9. Stopping Mr Crosby welcoming Yale, for example? (8)
10. Union in muddle over work. (6)
11. 16. The wealthy cockneys support the French. (6)
13. Old sweetheart seen in Surinam or Ethiopia. (6)
15. 3. Heart with Cupid's dart. (6)
16. See 3d.
18. Happiness found in single embrace. (4)
19. One of 16. Car smash? (9)

Down:

1. A 19. Volume found in poorest condition. (8)
2. Incompetent sailor and the French found on borders of Uzbekistan. (6)
3. & 16ac. They've started!! Hoy hid colossal crash! (6,8)
4. A type of 16. Article found between covers of book. (4)
6. One of 16. Former cabinet minister grabs dodgy money. (9)
7. Covered disturbingly deep novel. (9)
12. Letter from Roger dashed off in a morning. (8)
14. Square cigar blows up - calamitous! (6)
15. Crowd seen on track leading to old lodgings. (6)
17. Murdoch's flag? (4)

Answers to Crossword no. 52.

Across: 5. Acropetal. 8. Etna. 9. Mulberry. 10. Globin. 11. Hockey. 13. Stress. 15. Boxing. 16. Scurile. 18. Woad. 19. Gymnastics. Down: 1. Scrabble (sc=a quarter of Scottish). 2. Common. 3. Wealth. 4. Game. 6. Athletics. 7. Triennial. 12. Coxswain (pronounced Cockson). 14. Shinny. 15. Breast. 17. Rays (sounds like raise).

EDITORIAL POLICY

We welcome news, views and letters on any topic provided they are attributed to an author. We review all items for obvious libellous or offensive material, but we cannot check for factual content. Please do not send letters which are "not for publication". If you have strong feelings about what is or is not said in Mutterings, please either write to us or join the group of volunteers who enable the production of this village newsletter. Back issues of T'Owd Man's Mutterings can be found on the Bonsall Village website - www.bonsallvillage.org. Please note that your articles will appear on the Mutterings section of the website and can be picked up by search engines.

Answer to Collective Nouns: An Asylum

VILLAGE GROUPS & RESOURCES

Allotments Mike Lynch 820096

Art Club Maurice Fellows 822765

Bonsall Barn Project

Liz Stoppard/Mike Susko 823712

Bonsall Camp Matthew Quinn
07988071682

Bonsall Church Bell Ringers

Melissa Welbourne 826303

Bonsall Community Development

Trust Peter Greaves 822374

Bonsall Map Wendy Bullar 825267

Bonsall Pensioners Fund Ron Brown
822153

Bonsall Riders Club

Jane Williams 825632

Carnival Committee

Hazel Baldwin 824724

Chernobyl Children's Lifeline Group

Chris Broome 824512

Cromford Playgroup

Karen or Jayne 07909 937371

Horticultural Society

Ron Brown 822153

Kick-boxing

Hayley Capewell 0777 3149935

Mothers Union Di Moor 824376

Neighbourhood Watch

Alan David 822983

Open Gardens Ollie Gerrish 824498

Parents & Toddlers group

(Thursdays 1.45-3pm in term time)

Pigeon Club Gordon Hardy 823549

School Head, Lesley Murhall 822573

PTFA Theresa McClennon 580436

School Foundation

Clerk, Norma Rickards 822257

Rectory Room

For bookings, contact **Krystina Johnson**
on 823591

Village Hall

For bookings, contact **Leigh Johnson**
823591

Cost per session:

(a session is a morning, afternoon
or evening)

- **Village organisations:**
£10 – one floor, £16 – both floors
- **Non-village organisations:**
£20 – one floor, £30 – both floors
- **Village people private hire:**
£25 – one floor, £35 – both floors
- **Non-village people private hire:**
£40 – one floor, £50 – both floors.

Note: an extra charge for functions
where alcohol is sold: £20 for village or-
ganisations, £30 for non-village organisa-
tions, in addition to the hire charge.

TRAVEL SERVICES

Airports

Birmingham	0844 5766000
East Midlands	01332 852852
Manchester	0161 4893000

Bus services -TM Travel (M2)

Matlock. Monday to Saturday.

Departing Fountain: 08.08, 09.38, 10.38,
11.38, 12.38, 13.38, 14.38, 15.38*, 16.38*,
17.38 (all 3 mins earlier at Abel Lane).

Departing Co-op, Bakewell Rd:
09.15, 10.15, 11.15, 12.15, 13.15, 14.15,
15.15* 16.15*, 17.15.

* Saturdays and school holidays only

No Sunday or Bank Holiday service.

Pensioners free after 9.30 am. Details
from Traveline: 0871 2002233.

Derby. Service 212. Thursdays 9.05am
from the Fountain, depart from Eagle
Centre Market at 13.30.

Taxis 822072, 813774, 826060,
07967 273237, 07815 773706

Train services 0845 7484950

Travel line 0870 6082608

USEFUL NUMBERS

Health:

Chemists Hannage Brook 821750,
Wirksworth 822607

Dentists Matlock 584746, 55645,
582218, 56558

Doctors NHS Direct 0845 4647

Hannage Brook 822434

Hospitals

Chesterfield	01246 277271
Derby City	01332 340131
Derbys Royal	01332 347141
Whitworth	580211

Non-emergencies 111

Derbyshire County Council 580000
derbyshire.gov.uk

Derbyshire Dales District Council

All enquiries	761100
Building control	761321
Meeting dates	761300
Energy efficiency grants	761304
Environmental health	761212
House improvement grants	761118
Local plan	761251
Payments	761254
Recycling	761215
Refuse collection	761215
Street cleaning	761215
Swimming:	
Matlock (Arc)	581322
Wirksworth	824717
Planning	761336
Sports	761380

Tourist information:

Matlock	583388
Matlock Bath	583834
Trading Standards	585858

www.derbyshiredales.gov.uk

Electricity emergencies 0800 0568090

Fire station, Matlock 582849

Gas leaks 0800 111999

Household Waste Recycling Centre,
Harrison Way, Darley Dale, DE4 2LF.
Open 8.30 - 6.00 daily.

Mobile Library Every 2nd Thursday, for
details ring 01773 824333

Police/Safer neighbourhoods

(PC Malcolm Spencer and PCSO Laura
Coxhead) 0845 1233333
or matlock.neighbourhoods@derbyshire.
pnn.police.uk.
Crimestoppers 0800 555111
Victim support 825544
Antisocial behaviour coordinator 761187
Community safety 761101

Vets Matlock 582844, Matlock 581234,
Wirksworth 823034

Water emergencies 0800 7834444

RESOURCES

Bonsall Publications

The Bonsall Map

folded £2.50 (+£1 P&P to UK),
wall poster £3.50 (+ £ 9.90 P&P to UK),

History book

£15 paperback,
£25 hardback.

History Booklets – £2.50-3.00

or £10 for a pack of six.

Carnival Book – £9.99.

All available from 19 High St., DE4 2AS,
Tel: 825267, pubs or Fountain Tea rooms

History Walking Guides – £5

Peter Greaves 822374

CLASSIFIED ADS

Window cleaning. Pure water reach and wash pole service for residential or commercial properties. Ladder cleaning, gutter clearing house cleaning and car washing. Tel: 07531 485806 or 07964 732719

Holiday Cottages. Chestnut Farm, Uppertown. Five cottages can accommodate between 2 and 10 people. Phone Mike Nutting for details on 0779 9516128.

Ofsted Registered Childminder in Slaley now has vacancies on Mondays and Tuesdays all day and Friday mornings. Please call Emma on 01629 820252 or email emmac75@hotmail.co.uk for more information.

Picture Framing. Market Place, Wirksworth. Complete bespoke service, you name it we frame it, over 100 different mouldings in stock, very competitively priced. Mon to Sat open 10 to 5; closed on Weds. Tel 824994

Photography by Ian Daisley – family portraits, weddings, motorcycles, landscapes, tuition & private commissions. Tel. 07918 687624. www.iandaisleyphotography.com
www.probikeart.co.uk
www.highstonegallery.co.uk

H. Strange & Son

Electrical Engineers est. 1959
The Fountain, The Dale, Bonsall

- Domestic lighting and power systems
 - Night Storage Heating
 - Fire Alarm Systems
 - Emergency Lighting Systems
 - Telephone Extensions
 - Inspection Testing & Certification
 - Portable Appliance Testing
 - Emergency Callouts
 - Fault Finding & Rectification
 - Electric Underfloor Heating Systems
 - Minor Works & Repairs
 - Boiler & Central Heating Controls
- DCC Trusted Trader
Free competitive quotations on all our services

Tel: 01629 823241

Email: hstrangeandson@hotmail.co.uk

Web: www.hstrangeandson.co.uk

**FIRST SESSION
FREE ***



DOG WALKING

Fun, relief and exercise for your dog if you need to leave them for extended periods.

PET SITTING

For cats and caged animals. Leave your pet settled at home while you are away.

Visits from £5 for pet sitting, and £6.50 for dog walks

Call Sarah Curson for more info
01629 825962 Or 07790 820125

www.petsolutionsmatlock.co.uk

FULLY INSURED AND POLICE CHECKED

* For new customers. First visit, up to 30 minutes free. After a simple, free registration

Editorial Group

Hazel Baldwin	824724
Keith Falconer	823406
Peter Fellows	825267
Karen Firth	823311
Julie Hamilton	824819
Charlotte Harris	0754 3066360
Tanya Ivanova	0785 6247235
Nina Langton	823736
Pam McNally	826306
Ricky & Jeanette Moss	826557

Please send us your news, views, stories and diary events by noon **Wednesday 20 August 2014** to: Editorial Group, 19 High St. or by e-mail to: mutterings@hotmail.com

Acupuncture Acupressure & Remedial Massage

**Specialist treatment of
acute and chronic pain**

including:

Sciatica
Backpain
Frozen shoulder
Migraine
Fybromyalgia

also irritable bowel, fatigue,
depression, anxiety, asthma

Tel: 01629 580380

Mel Pickering MSc DipAc NTTA

Matlock Physiotherapy Centre, Edgefold Road

Cal Robinson

Building Works & Property
Maintenance

Tel: 01629 258107
Mob: 07867510551

City & Guilds
Time Served in Bricklaying and Construction



**STEVE ROBINSON
PLASTERING**



23 Yeoman st
Bonsall
Matlock Derbyshire
DE4 2AA
Phone: 01629824274
Mobile: 07752692245
steve_robbo@hotmail.com

Boxed and classified adverts are regarded as commercial advertising and attract a fee. Please call Peter Fellows for information about rates and lineage.

Copy for commercial advertising must be with us by the tenth of the month before you wish the advert to be placed.

Items for sale and wanted are free to villagers and can be submitted to mutterings@hotmail.com or hand-written to 19 High St.